

ECHELLE: 1:1

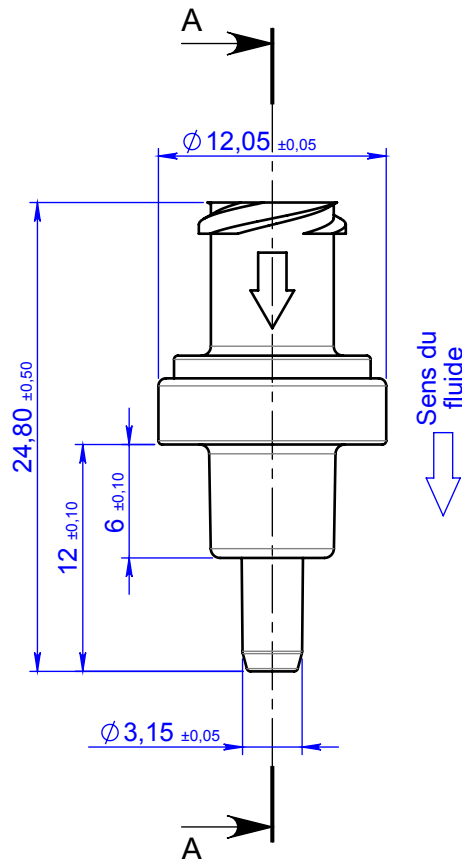

COUPE A-A

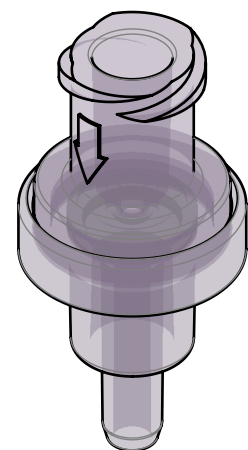
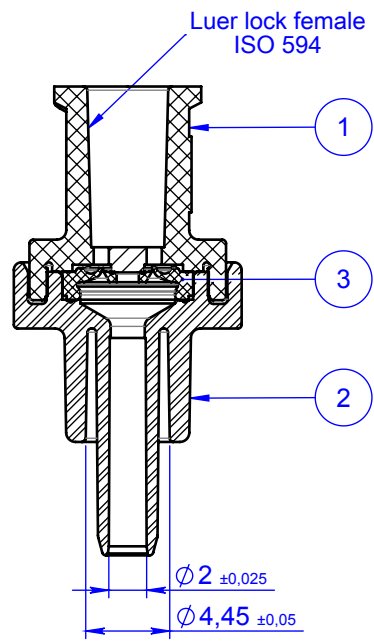

Sens du fluide

NOTA:

Rep	Matière	Code matière
1	PC	M0260
2		
3	SI	M0256

Opening pressure (after fabrication)	N/A
Opening pressure (when first used)	≤ 6 mbar
Opening pressure (after closure of the check valve)	≤ 12 mbar
Counterflow pressure resistance	8 bar
Pressure resistance in flow direction	8 bar
Blocking performance (leakage rate)	≤ 0.1 ml/h at a retrograde flow rate of 0.5 ml/h
Volumetric flow rate with 0.9% saline solution	≥ 150 ml/ min
Volumetric flow rate with Glucose 40%	≥ 110 ml/ min
Position sensitivity	Independent of position
Stand-by position	Closed
Priming volume	0.15 ml
Priming	airbubbles completely removable
Sterilization	ETO-Gas, γ-irradiation up to 50 kGy, steam sterilisable up to 121°C

00	08-05-2017	FRA	Création du plan	10344
Rev.	Date	Designer	Modification	N° FOR073 ou FOR021
Verif R&D : FDA Date : 25-09-2017		Verif QA : CGI Date : 03-10-2017		Verif client : Date :
Matière : SELON NOTA-SEE NOTE				Normes : ISO 594
Code matière : M0260 + M0256				Revision : 00
Reference : PBP47090				Etat : VALID
Designation : VALVE P.C TRANS. STEAM - PRESSION OUVERTURE 6 mBar - LLF - Ø 3x4.1mm				Echelle : 5:2
Tolérances générales :				
Unités : mm, °, grs				
				FOR035-2 P. 1 / 1 A4